

Discovery Marine

Isolator

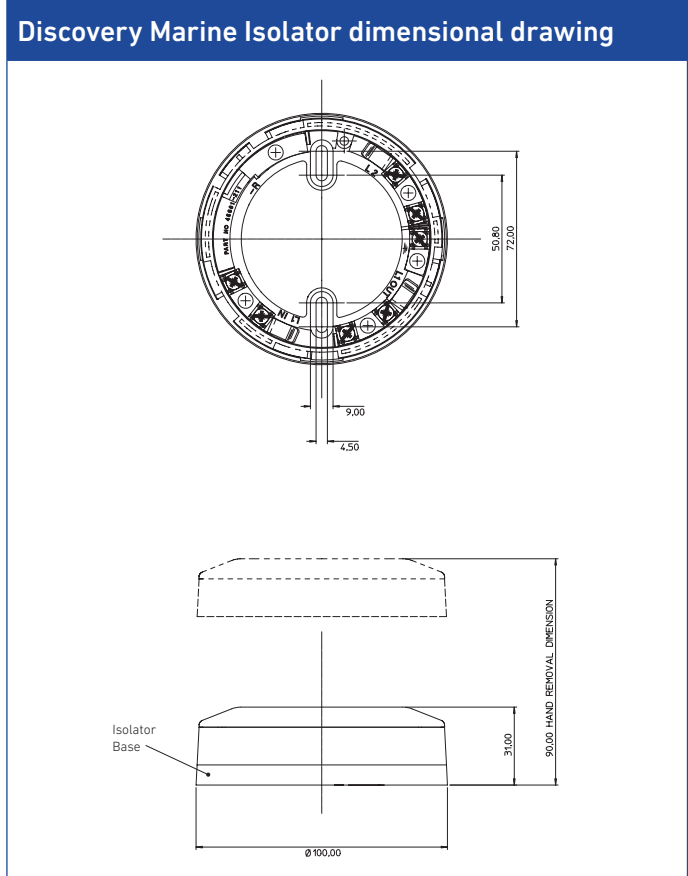

Marine Equipment Directive 2014/90/EU

The Discovery Marine Isolator complies with the essential requirements of the Marine Equipment Directive 2014/90/EU.

Product Overview

Product	Marine Isolator
Part No.	55000-721MAR

Approvals

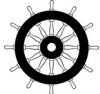

Product Information

The Discovery Marine Isolator is placed at intervals on the loop and ensures that, in the event of a short-circuit, only the section between isolators will be affected. When the short-circuit is removed the isolators automatically restore power in the isolated section. No more than 20 devices can be installed between isolators.

EMC Directive 2014/30/EU

The Discovery Marine Isolator complies with the essential requirements of the EMC Directive 2014/30/EU, provided that it is used as described in this data sheet.

A copy of the Declaration of Conformity is available from www.apollo-fire.co.uk.

Conformity of the Discovery Marine Isolator with the EMC Directive, does not confer compliance with the directive on any apparatus or systems connected to it.

Construction Products Regulation 305/2011/EU

The Discovery Marine Isolator complies with the essential requirements of the Construction Products Regulation 305/2011/EU.

A copy of the Declaration of Performance is available from www.apollo-fire.co.uk.

36 Brookside Road, Havant | Tel: +44 (0)23 9249 2412 | Email: sales@apollo-fire.com
 Hampshire, PO9 1JR, UK. | Fax: +44 (0)23 9249 2754 | Web: www.apollo-fire.co.uk



A HALMA COMPANY

© Apollo Fire Detectors Limited 2017



This page has intentionally been left blank